

Daniel "Danny" Mayfield
Commissioner, District 1

Virginia Vigil
Commissioner, District 2

Robert A. Anaya
Commissioner, District 3

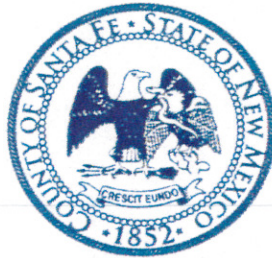

Kathy Holian
Commissioner, District 4

Liz Stefanics
Commissioner, District 5

Katherine Miller
County Manager

MEMORANDUM

Date: September 13, 2011

To: Board of County Commissioners

From: Erle Wright, Data Integration Administrator, GIS Division *EW*

Via: Jack Kolkmeier, Director, Growth Management Department *JK*

Subject: Continuation of Presentation of Draft County Commission Redistricting Plans

Issue

The Santa Fe County GIS Division has prepared and presented a total of eleven (11) redistricting plan options at the August 9 and August 30, 2011 Commission meetings. The Board at its August 30, 2011 meeting eliminated all but five (5) of these plans for further consideration. The remaining five (5) redistricting plan options are open for the Board's review, consideration and discussion.

Background

The 2010 Decennial Census data for Santa Fe County has revealed that Santa Fe County's County Commission districts must be adjusted in order to balance population as equally as possible among each of the five districts. The basic principles of districting (Equal Population, Avoid Dilution of Minority Voting Strength, Compactness, Contiguity, and Maintenance of Communities of Interest) have been applied to all options brought forward for the Board's consideration.

Based upon direction received from the Board at its July 12, 2011 and July 26, 2011 meetings, the GIS Division prepared and presented three (3) redistricting scenarios/plans for the Board's consideration. After reviewing each of these three options at its August 9, 2011 meeting, the Board requested that new variations of these redistricting scenarios/plans be prepared. Eight (8) new redistricting plan options developed in response to the Board's requests were presented at the Board's August 30, 2011 meeting. Having reviewed and discussed all eleven (11) redistricting plan options, the Board eliminated six (6) options from further consideration.

Attached are the remaining five (5) redistricting plan options, an updated statistical summary table for these options, a narrative description document and an updated Redistricting Timeline document.

Action

Five (5) redistricting plan options remain open for the Board's review, consideration and discussion. The only actions needed from the Board today are continued a review and discussion of each remaining option, possible elimination of any of these remaining options from further consideration, and possible suggestions for further plan refinement and/or preparation. Such actions today will facilitate efficient and effective Public Hearings concerning final proposed plans on September 27 and October 11. Final plan selection and adoption is targeted for the October 11, 2011 Board meeting.

Santa Fe County Re-Districting Process

Steps to Accomplish:

- I. Receive an authorization letter from the New Mexico Secretary of State to approve the State's Precinct Boundary Adjustments in accordance with the Precinct Boundary Adjustment Act, NMSA 1978, Sections 1-3-10 to 1-3-14. **May 31, 2011**
- II. Present the Secretary of State's Authorization Letter at a Board of County Commission Meeting and obtain Board approval of the State's Precinct Boundary Adjustments. **June 28, 2011**
- III. Upon completion of the Precinct Boundary Adjustment maps with the written precinct description, send such information electronically to the Secretary of State for approval in accordance with NMSA 1978, Section 1-3-12C(2). **Approval received July 11, 2011**
- IV. County Staff to Develop Scenarios/Plans for redistricting of the Commission Districts based upon approved precinct boundaries by the Secretary of State. **July - August 2011**
July 12 – Commission establishes parameters for developing redistricting scenarios/plans
July 26 – Commission requests first drafts of redistricting scenarios/plans be prepared for further review and Public Input
August 9 – presented first draft of redistricting scenarios/plans (3) for Commission review; Commission requests additional redistricting scenarios/plans be prepared
- V. Public Input to redistricting process will be as directed by BCC: Redistricting will be a recurring Agenda Item on regularly scheduled BCC Meetings (2nd and last Tuesday of each month) to collect feedback from Citizens on proposed redistricting scenarios/plans.
July – September 2011
- VI. Refine Scenarios/Plans based on Citizen Input and Commission Direction.
August - September 2011
August 30 – presented new and/or modified redistricting scenarios/plans (8) for Commission review and Public Input. Six (6) plans eliminated from further consideration.
September 13 – *Final review of redistricting scenarios/plans prior to formal Public Hearings*
- VII. Board of County Commissioners Authorizes Publication of Title and General Summary of Ordinance to Adopt 2011 Redistricting Plan. **Publication Authorized August 30, 2011**
- VIII. Conduct 1st Public Hearing on 2011 Redistricting Plan. **September 27, 2011**
- IX. Conduct 2nd Public Hearing on 2011 Redistricting Plan and Act upon Ordinance to Adopt 2011 Redistricting Plan. **October 11, 2011**

Steps	May '11	June '11	July '11	August '11	September '11	October '11
I.	Completed					
II.		Completed				
III.			Completed			
IV.			Completed			
V.			Ongoing			
VI.				Ongoing		
VII.				Completed		
VIII.					Scheduled	
IX.						Scheduled

Note: "Ideal Population" by District is **28,834 people** (144,170/5) with an allowance of +/- 1,442 people (5% of 28,834)

Narrative Description of Redistricting Options
will be Delivered Electronically on Friday
and in hardcopy form at Tuesday's BCC Meeting

My sincere apologies for this delay

Erle Wright
Data Integration Administrator

Population Breakdown of Current Santa Fe County Commission Districts and Proposed Redistricting Options

CURRENT CONDITIONS

2010 Total County Population by Race		Hispanic		White		Native American		Non-Hispanic Origin		Asian & Other		2 or More Races		Estimated Urban Population	
Total Population	Ideal Population per Commission District	73,015	50.6%	63,291	43.9%	3,271	2.3%	947	0.7%	1,963	1.4%	1,683	1.2%	86,201	59.8%
144,170	28,834														

2010 Totals for Existing Commission Districts

Comm. Dist.	Pct. Cnt.	Population per District	Deviation (max +/- 5%)	Hispanic		White		Native American		Non-Hispanic Origin		Asian & Other		2 or More Races		Estimated Urban Population		
				14,089	54.1%	9,654	37.1%	1,635	6.3%	118	0.5%	279	1.1%	248	1.0%	12,120	46.6%	
1	24	26,023	-2,811	-9.75%	14,089	54.1%	9,654	37.1%	1,635	6.3%	118	0.5%	279	1.1%	248	1.0%	12,120	46.6%
2	16	28,164	-670	-2.32%	14,564	51.7%	12,430	44.1%	338	1.2%	165	0.6%	355	1.3%	312	1.1%	19,166	68.0%
3	14	32,842	4,008	13.90%	18,682	56.9%	12,711	38.7%	461	1.4%	203	0.8%	429	1.3%	356	1.1%	21,003	64.0%
4	19	26,045	-2,789	-9.67%	10,486	40.3%	14,230	54.6%	320	1.2%	185	0.7%	445	1.7%	379	1.5%	18,776	72.1%
5	15	31,096	2,262	7.84%	15,194	48.9%	14,266	45.9%	517	1.7%	276	0.9%	455	1.5%	388	1.2%	15,136	48.7%

Totals for Proposed Redistricting Options

Comm. Dist.	Pct. Cnt.	Population per District	Deviation (max +/- 5%)	Hispanic		White		Native American		Non-Hispanic Origin		Asian & Other		2 or More Races		Estimated Urban Population		
				14,303	51.9%	10,910	39.6% <th>1,658</th> <th>6.0% <th>120</th> <th>0.4% <th>302</th> <th>1.1% <th>276</th> <th>1.0% <th>12,893</th> <th>46.8% </th></th></th></th></th>	1,658	6.0% <th>120</th> <th>0.4% <th>302</th> <th>1.1% <th>276</th> <th>1.0% <th>12,893</th> <th>46.8% </th></th></th></th>	120	0.4% <th>302</th> <th>1.1% <th>276</th> <th>1.0% <th>12,893</th> <th>46.8% </th></th></th>	302	1.1% <th>276</th> <th>1.0% <th>12,893</th> <th>46.8% </th></th>	276	1.0% <th>12,893</th> <th>46.8% </th>	12,893	46.8%	
1	25	27,569	-1,265	-4.39%	14,303	51.9%	10,910	39.6%	1,658	6.0%	120	0.4%	302	1.1%	276	1.0%	12,893 <td>46.8%</td>	46.8%
2	14	29,833	999	3.46%	18,025	60.4%	10,626	35.6%	366	1.2%	188	0.6%	322	1.1%	306	1.0%	21,608 <td>72.4%</td>	72.4%
3	13	27,952	-882	-3.06%	14,663	52.5%	12,014	43.0%	395	1.4%	167	0.6%	401	1.4%	312	1.1%	16,113 <td>57.6%</td>	57.6%
4	22	29,304	470	1.63%	11,411	38.9%	16,413	56.0%	347	1.2%	209	0.7%	497	1.7%	427	1.5%	22,035 <td>75.2%</td>	75.2%
5	14	29,512	678	2.35%	14,613	49.5%	13,328	45.2%	505	1.7%	263	0.9%	441	1.5%	362	1.2%	13,552 <td>45.9%</td>	45.9%
Option B1																		
1	26	29,342	508	1.76%	16,064	54.7%	10,759	36.7%	1,700	5.8%	150	0.5%	338	1.2%	331	1.1%	15,439 <td>52.6%</td>	52.6%
2	10	28,498	-336	-1.17%	18,829	66.1%	8,674	30.4%	350	1.2%	154	0.5%	263	0.9%	228	0.8%	19,500 <td>68.4%</td>	68.4%
3	13	28,292	-542	-1.88%	14,737	52.1%	12,204	43.1%	405	1.4%	177	0.6%	445	1.6%	324	1.1%	16,453 <td>58.2%</td>	58.2%
4	23	29,541	707	2.45%	10,418	35.3%	17,687	59.9%	316	1.1%	198	0.7%	505	1.7%	417	1.4%	21,198 <td>71.8%</td>	71.8%
5	16	28,497	-337	-1.17%	12,967	45.5%	13,967	49.0%	500	1.8%	268	0.9%	412	1.4%	383	1.3%	13,611 <td>47.8%</td>	47.8%
Option C2																		
1	26	29,627	793	2.75%	15,253	51.5%	11,839	40.0%	1,696	5.7%	146	0.5%	358	1.2%	335	1.1%	14,951 <td>50.5%</td>	50.5%
2	11	29,385	551	1.91%	19,852	67.6%	8,499	28.9%	362	1.2%	163	0.6%	264	0.9%	245	0.8%	21,160 <td>72.0%</td>	72.0%
3	13	28,292	-542	-1.88%	14,737	52.1%	12,204	43.1%	405	1.4%	177	0.6%	445	1.6%	324	1.1%	16,453 <td>58.2%</td>	58.2%
4	22	28,369	-465	-1.61%	10,206	36.0%	16,782	59.2%	308	1.1%	193	0.7%	484	1.7%	396	1.4%	20,026 <td>70.6%</td>	70.6%
5	16	28,497	-337	-1.17%	12,967	45.5%	13,967	49.0%	500	1.8%	268	0.9%	412	1.4%	383	1.3%	13,611 <td>47.8%</td>	47.8%
Option C3																		
1	26	29,411	577	2.00%	15,095	51.3%	11,838	40.3%	1,670	5.7%	140	0.5%	354	1.2%	314	1.1%	14,735 <td>50.1%</td>	50.1%
2	11	29,385	551	1.91%	19,852	67.6%	8,499	28.9%	362	1.2%	163	0.6%	264	0.9%	245	0.8%	21,160 <td>72.0%</td>	72.0%
3	13	28,292	-542	-1.88%	14,737	52.1%	12,204	43.1%	405	1.4%	177	0.6%	445	1.6%	324	1.1%	16,453 <td>58.2%</td>	58.2%
4	22	28,585	-249	-0.86%	10,364	36.3%	16,783	58.7%	334	1.2%	199	0.7%	488	1.7%	417	1.5%	20,242 <td>70.8%</td>	70.8%
5	16	28,497	-337	-1.17%	12,967	45.5%	13,967	49.0%	500	1.8%	268	0.9%	412	1.4%	383	1.3%	13,611 <td>47.8%</td>	47.8%
Option C4																		
1	26	29,348	514	1.78%	15,424	52.6%	11,419	38.9%	1,681	5.7%	152	0.5%	354	1.2%	318	1.1%	15,445 <td>52.6%</td>	52.6%
2	11	29,646	812	2.82%	19,432	65.5%	9,180	31.0%	359	1.2%	158	0.5%	273	0.9%	244	0.8%	20,648 <td>69.6%</td>	69.6%
3	13	28,292	-542	-1.88%	14,737	52.1%	12,204	43.1%	405	1.4%	177	0.6%	445	1.6%	324	1.1%	16,453 <td>58.2%</td>	58.2%
4	22	28,387	-447	-1.55%	10,455	36.8%	16,521	58.2%	326	1.1%	192	0.7%	479	1.7%	414	1.5%	20,044 <td>70.6%</td>	70.6%
5	16	28,497	-337	-1.17%	12,967	45.5%	13,967	49.0%	500	1.8%	268	0.9%	412	1.4%	383	1.3%	13,611 <td>47.8%</td>	47.8%

Notes: "Ideal Population" by District is 28,834 people (144,170/5) with an allowance of +/- 1,442 people (5% of 28,834). Options B, B2, C, C1, D and D1 were eliminated from further consideration at August 30, 2011 County Commission meeting.

Santa Fe County 2011 Redistricting Option A

DRAFT

Legend

- Redistricting Option A
- District 1
 - District 2
 - District 3
 - District 4
 - District 5
 - Former District Boundaries
 - 2011 Precinct Boundaries
 - Incorporated Areas
 - Roads
 - Railroads

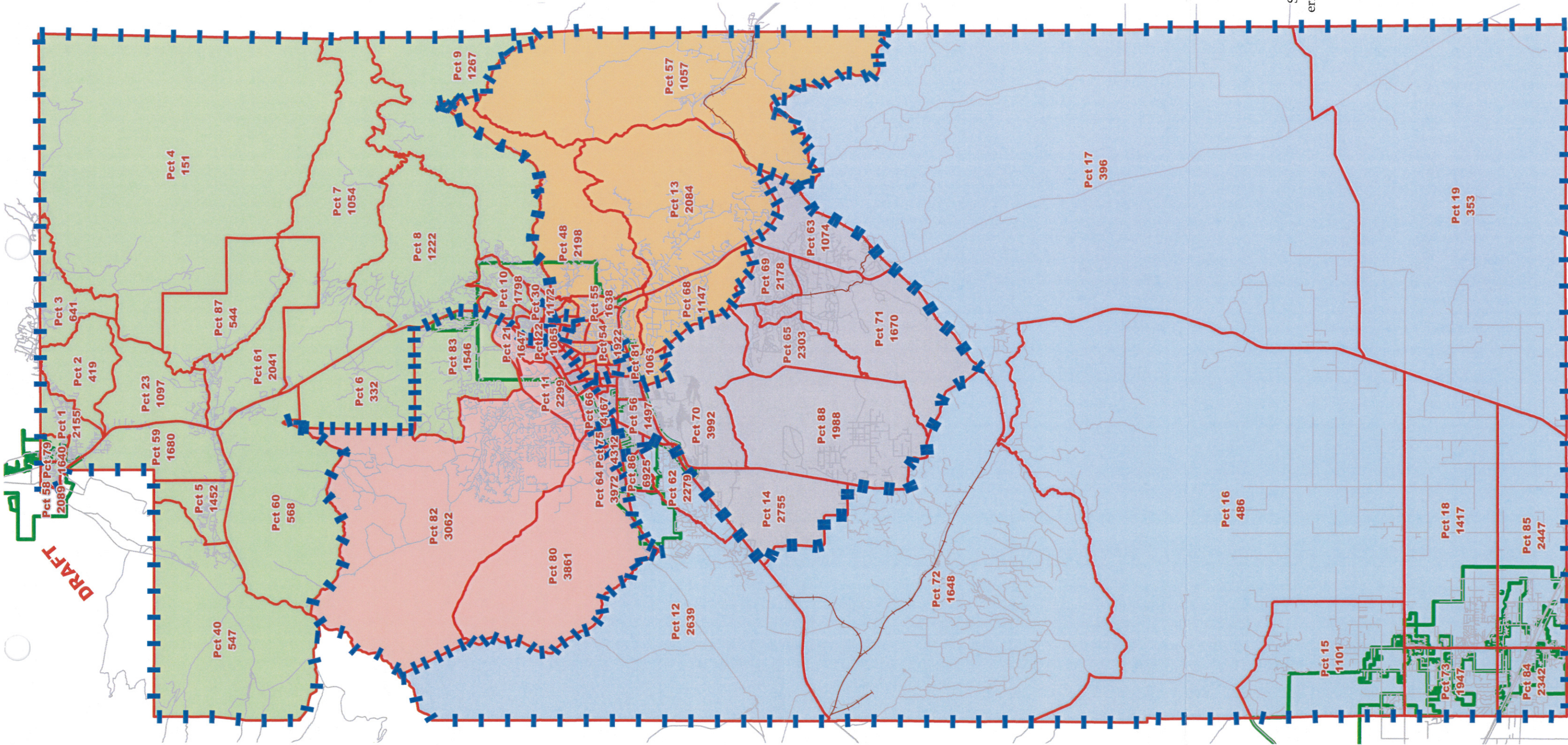

1:260,000

1 inch approximately 4 miles

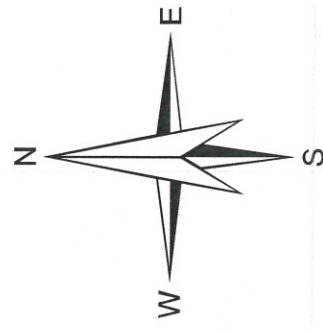

North American Vertical Datum 1988

This information is for reference only.
Santa Fe County assumes no liability for errors associated with the use of these data.
Users are solely responsible for confirming data accuracy.

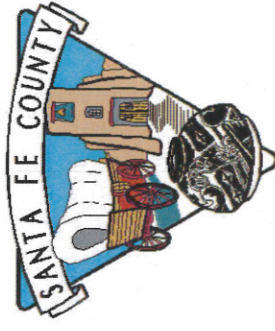

DRAFT

Santa Fe County 2011 Redistricting Option A

DRAFT

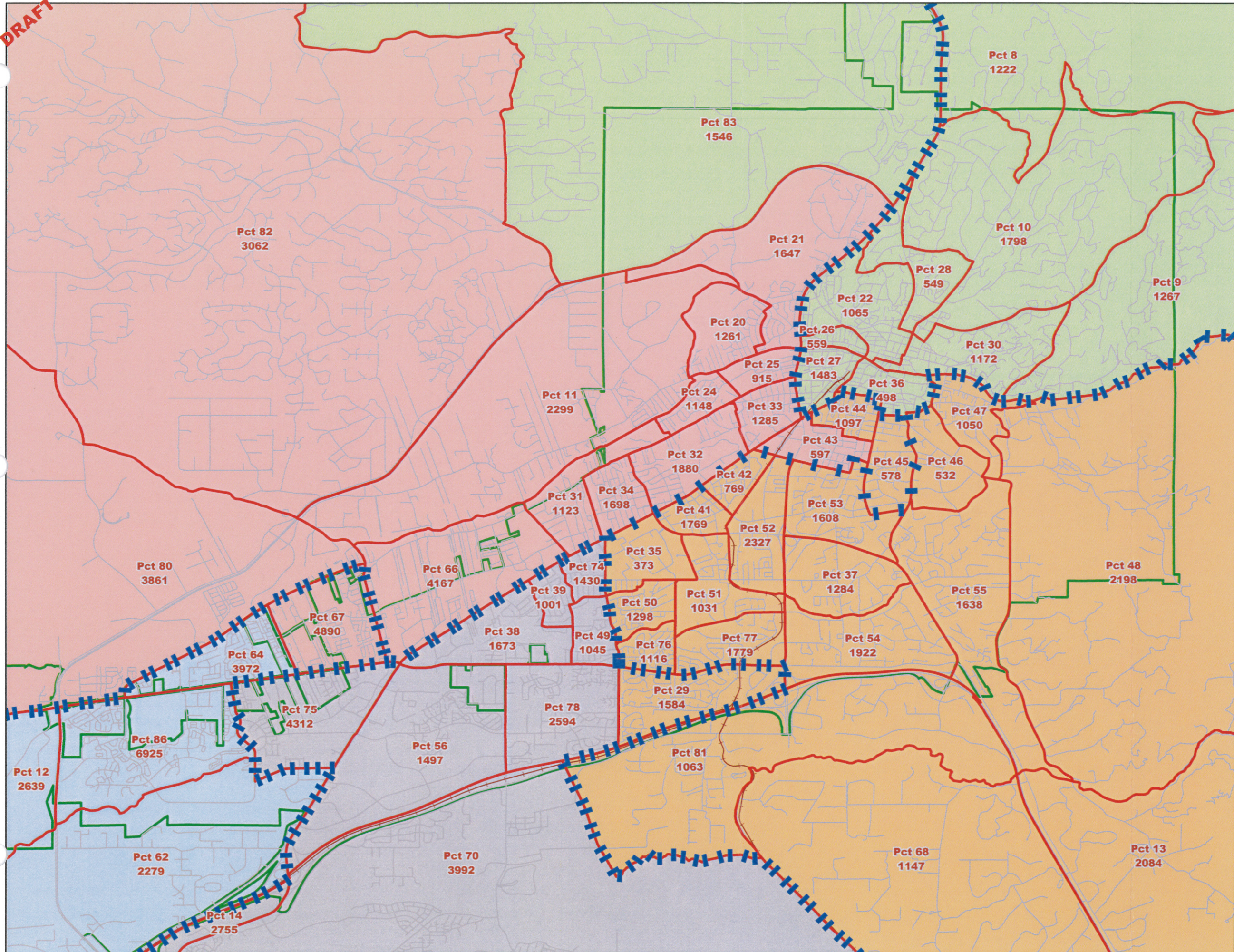

- Legend**
- Redistricting Option A
 - District 1
 - District 2
 - District 3
 - District 4
 - District 5
 - Former District Boundaries
 - 2011 Precinct Boundaries
 - Incorporated Areas
 - Roads

1:63,360
1 inch represents 1 mile

Miles

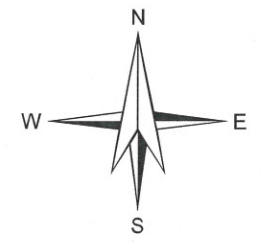

North American Vertical Datum 1988

This information is for reference only.
Santa Fe County assumes no liability for
errors associated with the use of these data.
Users are solely responsible for
confirming data accuracy.



August 1, 2011

Santa Fe County 2011 Redistricting Option B1

DRAFT

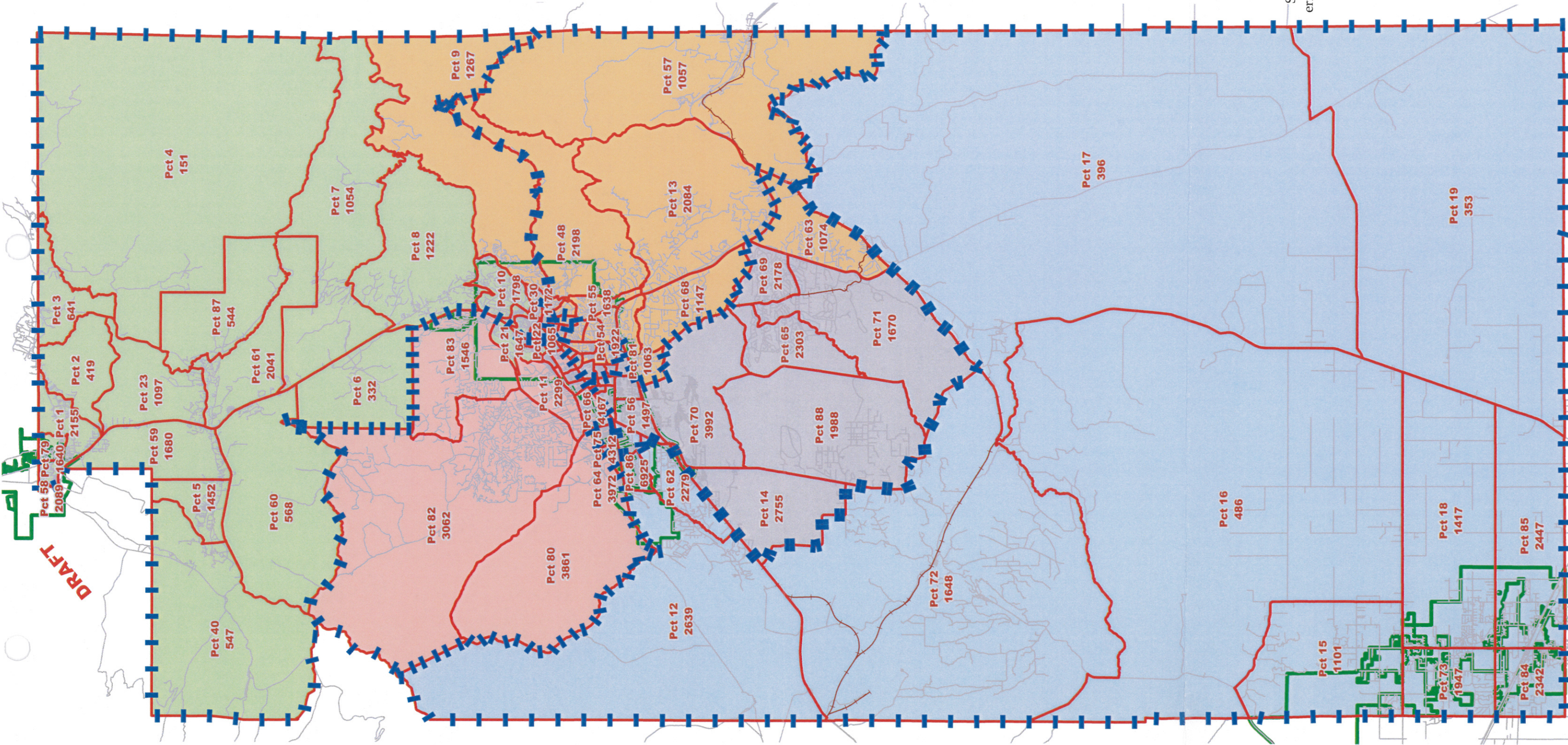

Legend

Redistricting Option B1

- District 1
- District 2
- District 3
- District 4
- District 5

Former District Boundaries

2011 Precinct Boundaries

Incorporated Areas

Roads

Railroads

1:260,000

1 inch approximately 4 miles

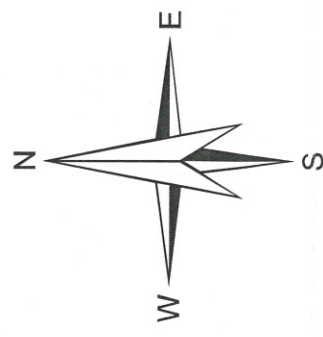

North American Vertical Datum 1988

This information is for reference only.
Santa Fe County assumes no liability for errors associated with the use of these data.
Users are solely responsible for confirming data accuracy.

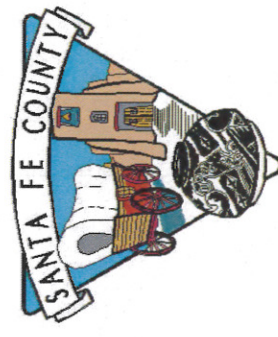

DRAFT

Santa Fe County 2011 Redistricting Option B1

DRAFT

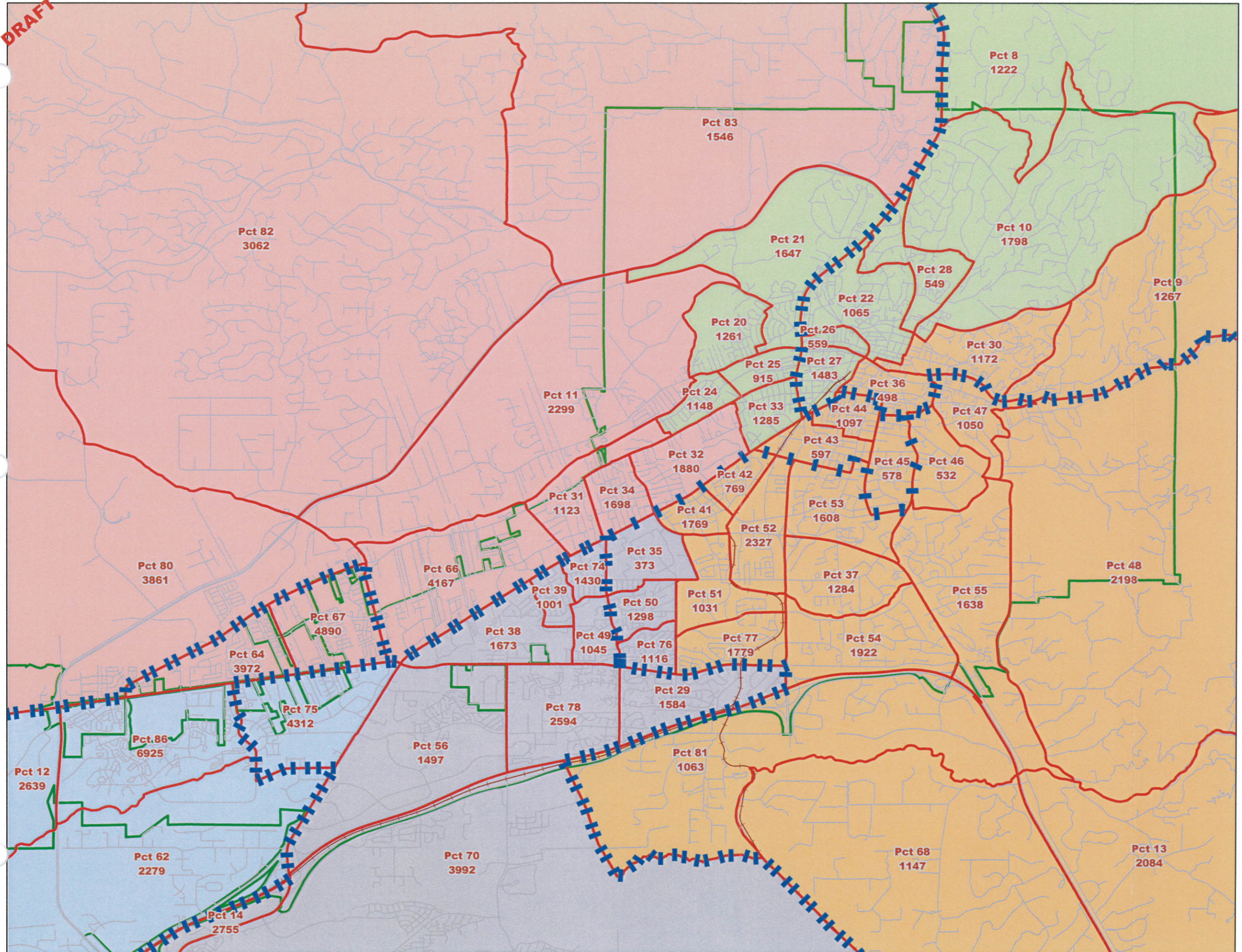

- Legend**
- Redistricting Option B1
 - District 1
 - District 2
 - District 3
 - District 4
 - District 5
 - Former District Boundaries
 - 2011 Precinct Boundaries
 - Incorporated Areas
 - Roads

1:63,360
1 inch represents 1 mile

Miles

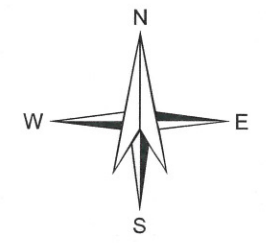

North American Vertical Datum 1988

This information is for reference only.
Santa Fe County assumes no liability for
errors associated with the use of these data.
Users are solely responsible for
confirming data accuracy.



August 24, 2011

Santa Fe County 2011 Redistricting Option C2

DRAFT

Legend

- Redistricting Option C2
- District 1
 - District 2
 - District 3
 - District 4
 - District 5
 - Former District Boundaries
 - 2011 Precinct Boundaries
 - Incorporated Areas
 - Roads
 - Railroads

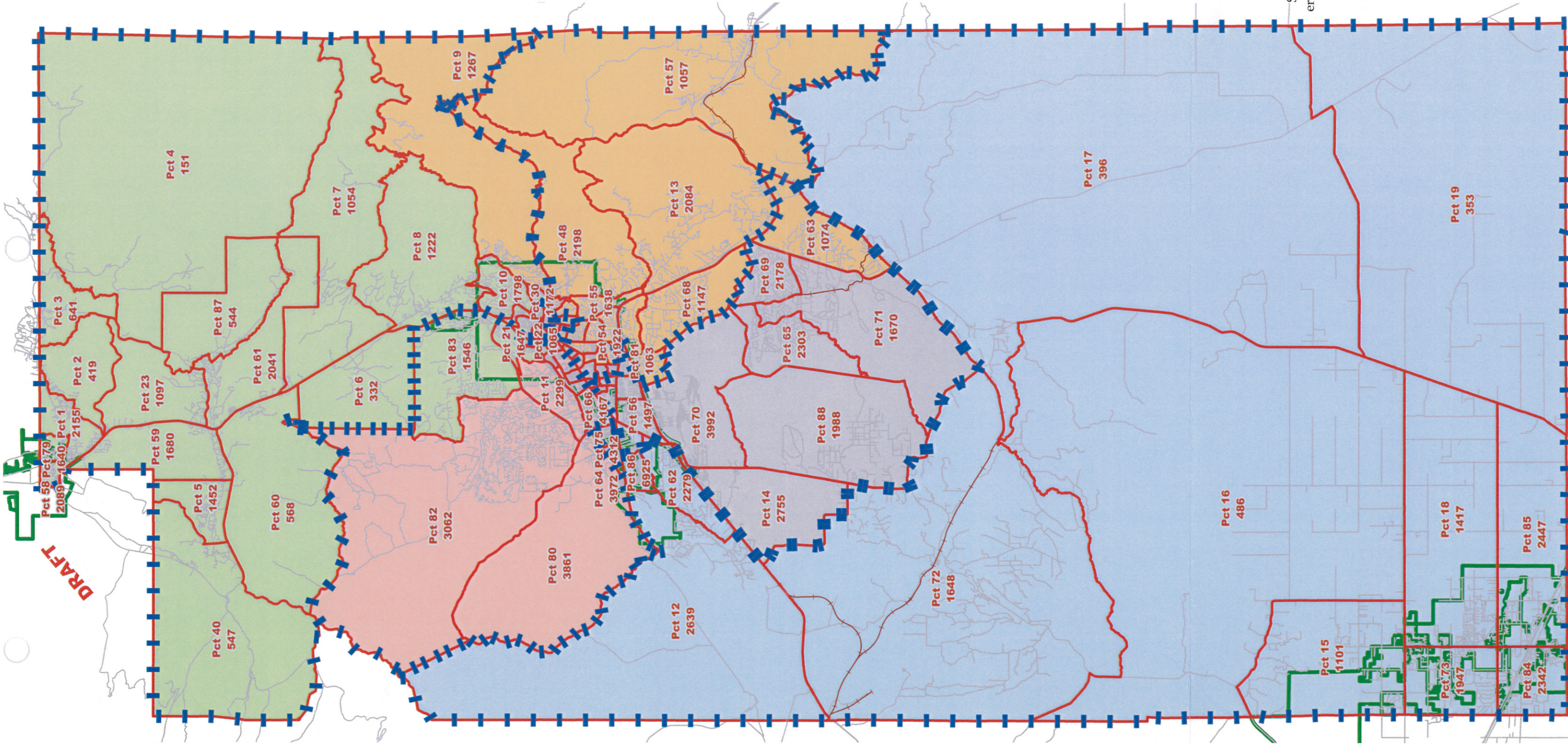

1:260,000

1 inch approximately 4 miles

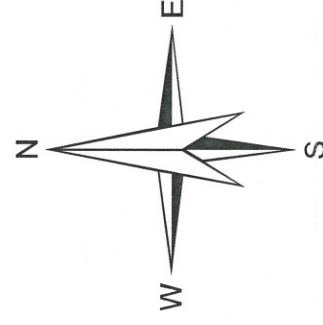

North American Vertical Datum 1988

This information is for reference only.
Santa Fe County assumes no liability for errors associated with the use of these data.
Users are solely responsible for confirming data accuracy.



DRAFT

Santa Fe County 2011 Redistricting Option C2

DRAFT

Legend

Redistricting Option C2

- District 1
- District 2
- District 3
- District 4
- District 5
- Former District Boundaries
- 2011 Precinct Boundaries
- Incorporated Areas
- Roads

1:63,360

1 inch represents 1 mile

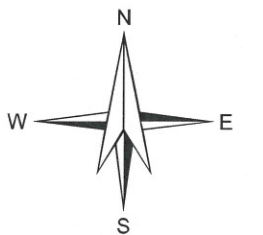

North American Vertical Datum 1988

This information is for reference only. Santa Fe County assumes no liability for errors associated with the use of these data. Users are solely responsible for confirming data accuracy.



August 24, 2011

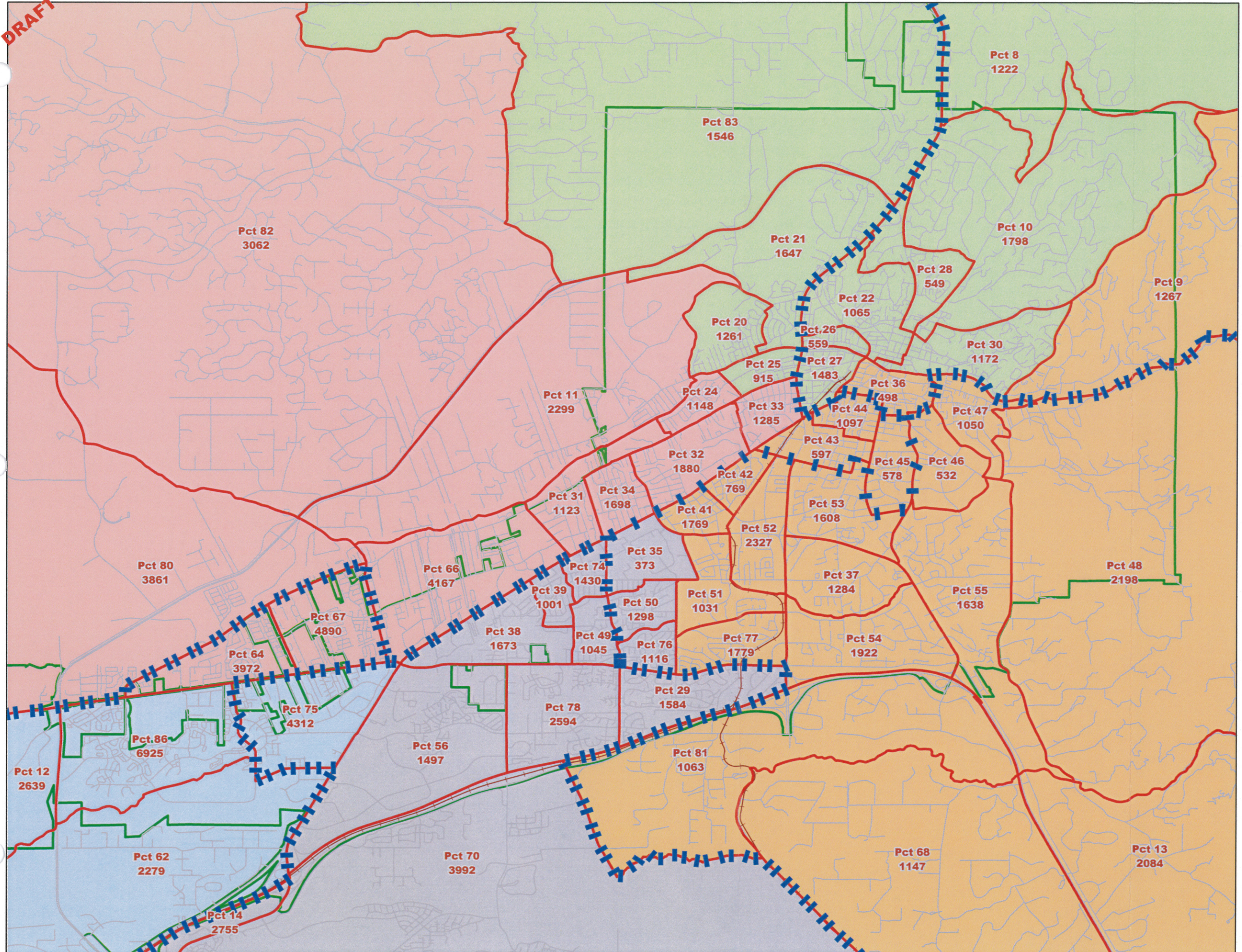

Santa Fe County 2011 Redistricting Option C3

DRAFT

Legend

- Redistricting Option C3
- District 1
 - District 2
 - District 3
 - District 4
 - District 5
 - Former District Boundaries
 - 2011 Precinct Boundaries
 - Incorporated Areas
 - Roads
 - Railroads

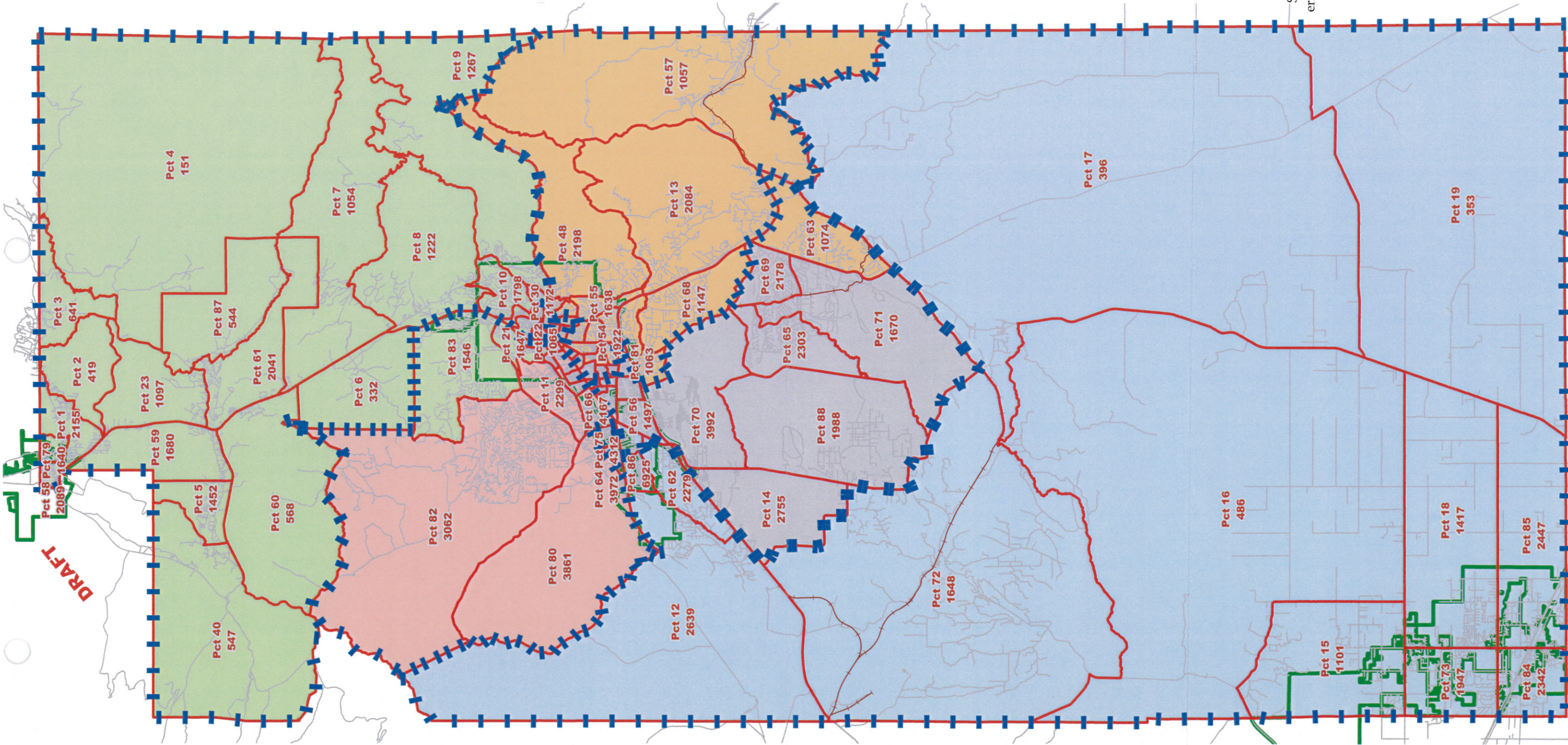

1:260,000

1 inch approximately 4 miles

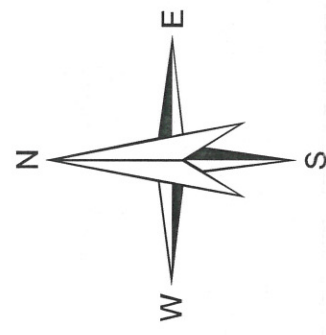

North American Vertical Datum 1988

This information is for reference only.
Santa Fe County assumes no liability for errors associated with the use of these data.
Users are solely responsible for confirming data accuracy.



DRAFT

Santa Fe County 2011 Redistricting Option C3

DRAFT

Legend

Redistricting Option C3

- District 1
- District 2
- District 3
- District 4
- District 5
- Former District Boundaries
- 2011 Precinct Boundaries
- Incorporated Areas
- Roads

1:63,360

1 inch represents 1 mile

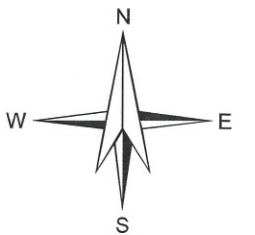
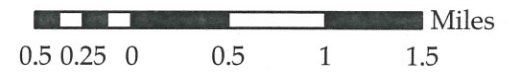

North American Vertical Datum 1988

This information is for reference only.
 Santa Fe County assumes no liability for
 errors associated with the use of these data.
 Users are solely responsible for
 confirming data accuracy.



August 24, 2011

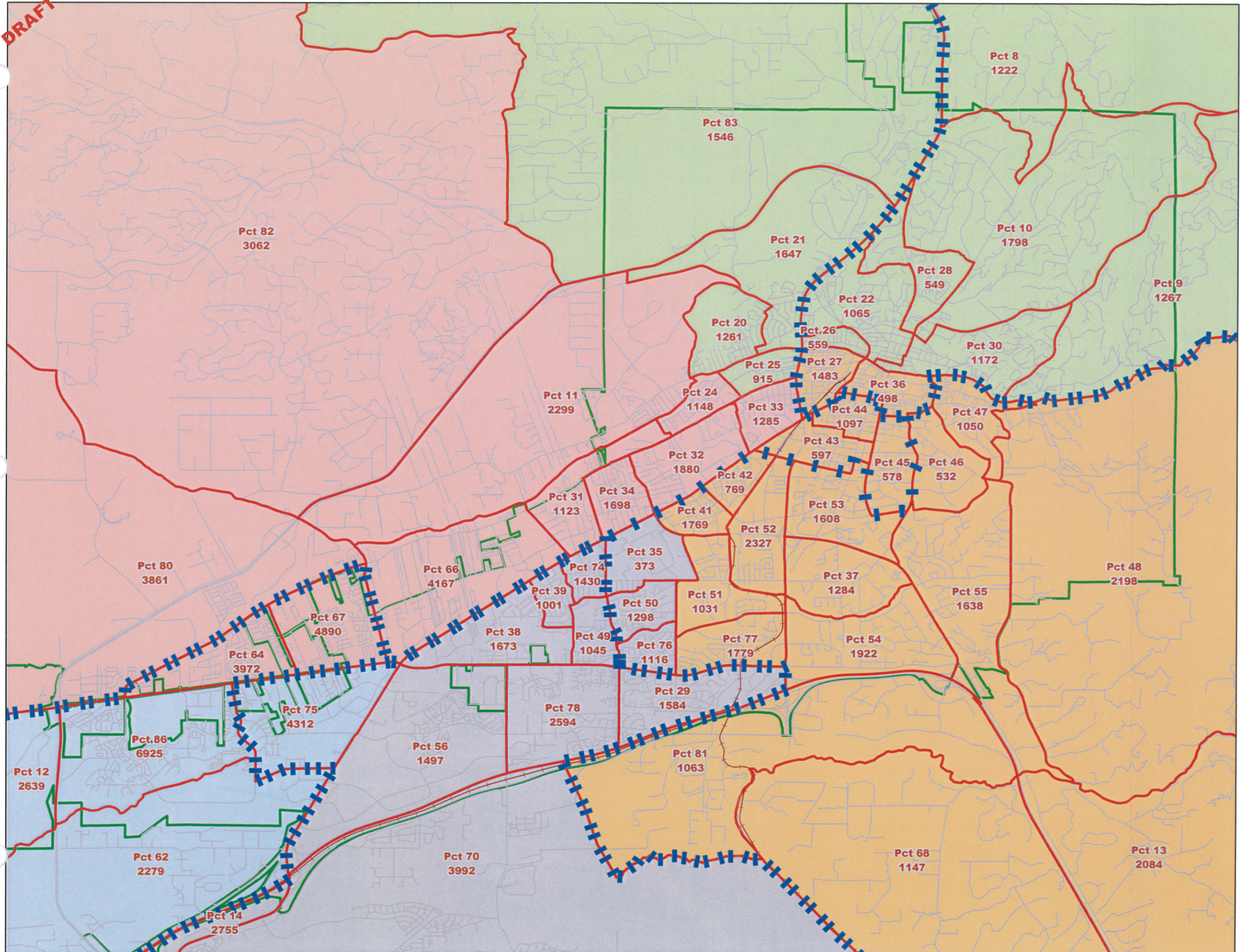

Santa Fe County 2011 Redistricting Option C4

DRAFT

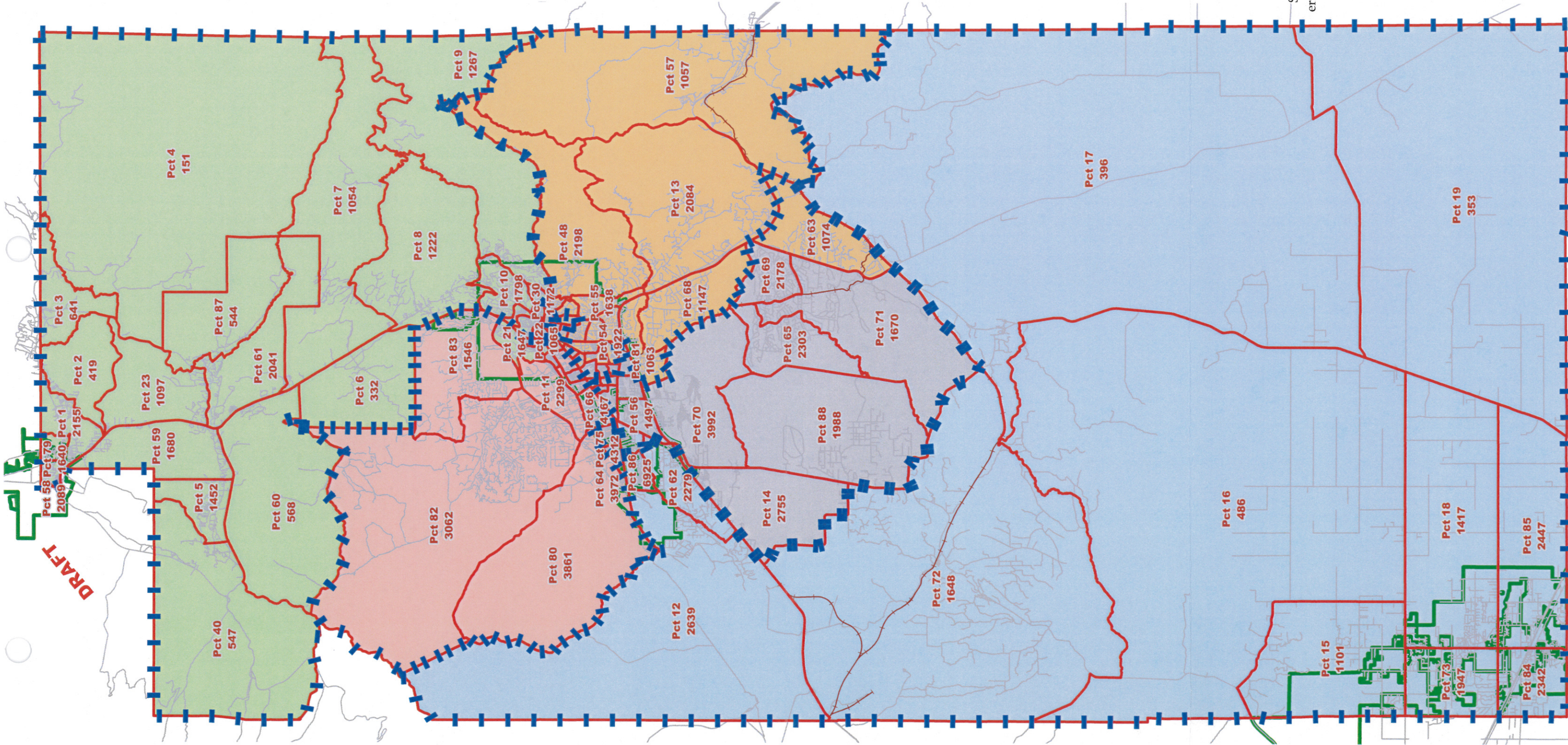

Legend

- Redistricting Option C4
- District 1
 - District 2
 - District 3
 - District 4
 - District 5
 - Former District Boundaries
 - 2011 Precinct Boundaries
 - Incorporated Areas
 - Roads
 - Railroads

1:260,000

1 inch approximately 4 miles

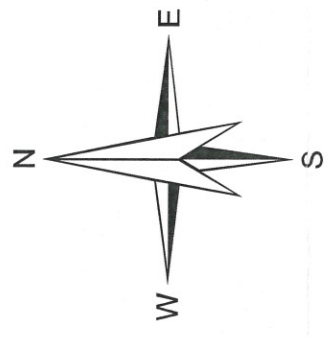

North American Vertical Datum 1988

This information is for reference only.
Santa Fe County assumes no liability for errors associated with the use of these data.
Users are solely responsible for confirming data accuracy.

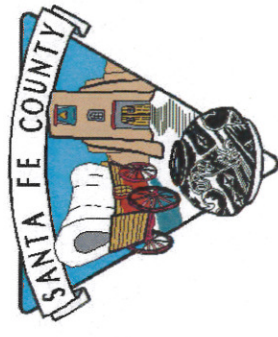

DRAFT

Santa Fe County 2011 Redistricting Option C4

DRAFT

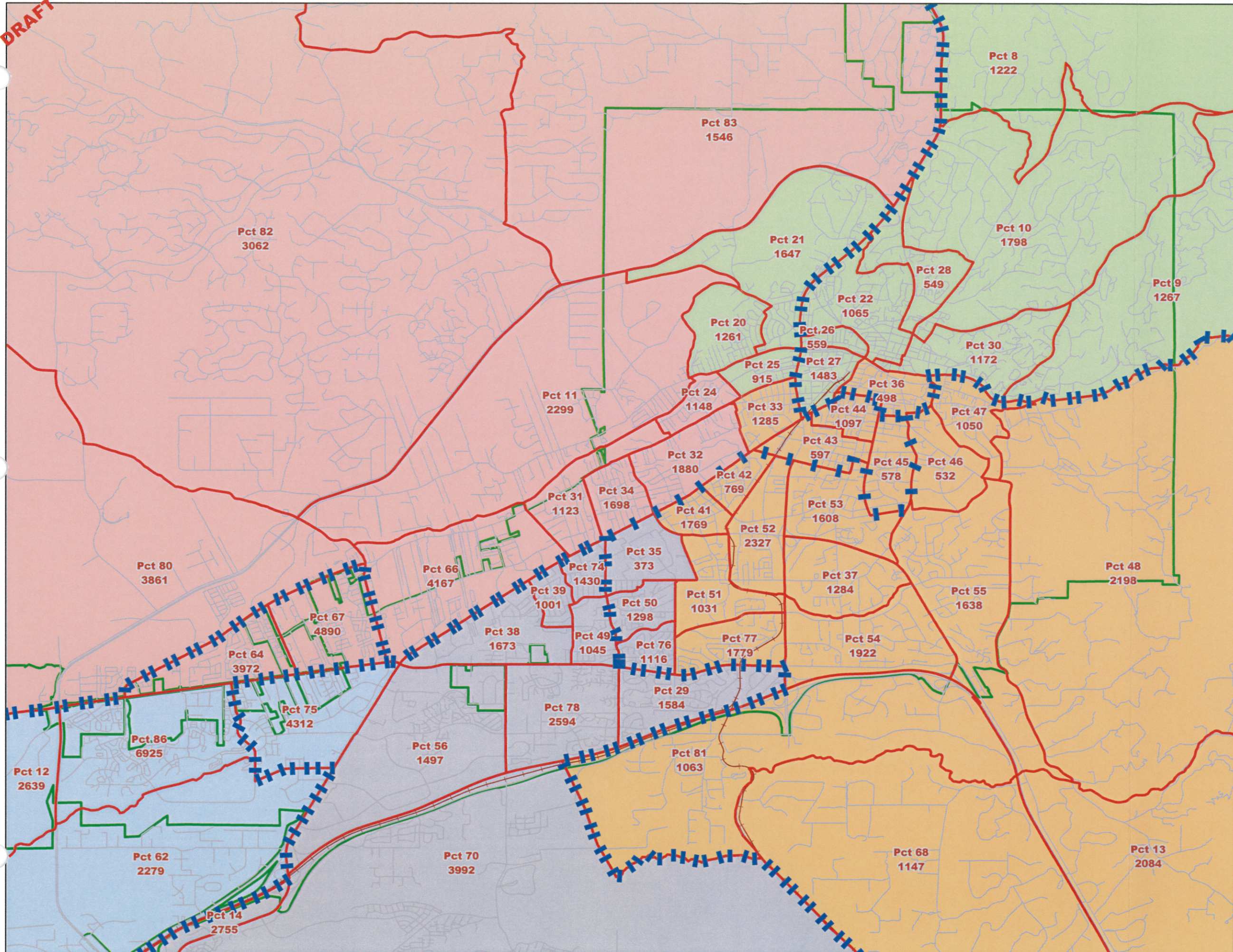

- Legend**
- Redistricting Option C4
- District 1
 - District 2
 - District 3
 - District 4
 - District 5
 - Former District Boundaries
 - 2011 Precinct Boundaries
 - Incorporated Areas
 - Roads

1:63,360
1 inch represents 1 mile

Miles

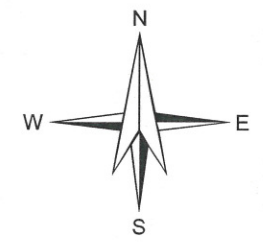

North American Vertical Datum 1988

This information is for reference only.
Santa Fe County assumes no liability for
errors associated with the use of these data.
Users are solely responsible for
confirming data accuracy.



August 24, 2011

**NO PACKET MATERIAL
FOR THIS ITEM**