

Daniel "Danny" Mayfield
Commissioner, District 1

Virginia Vigil
Commissioner, District 2

Robert A. Anaya
Commissioner, District 3

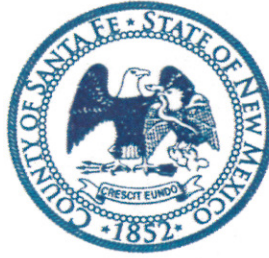

Kathy Holian
Commissioner, District 4

Liz Stefanics
Commissioner, District 5

Katherine Miller
County Manager

MEMORANDUM

Date: October 11, 2011

To: Board of County Commissioners

From: Erle Wright, Data Integration Administrator, GIS Division *AEW*

Via: Jack Kolkmeyer, Director, Growth Management Department *JK*

Subject: **Second Public Hearing – Ordinance 2011- _____, Adopting the Santa Fe County 2011 Redistricting Plan**

Issue

A final 2011 County Commission Redistricting Plan is ready for adoption by the Santa Fe County Board of County Commissioners following months of work and the appropriate Public Hearings.

Background

The task of redistricting is performed every 10 years following the each decennial census. It is necessary to ensure that the populations of the commission districts in the county are nearly equal. Santa Fe County moved from a three (3) member to five (5) member County Commission under the authority of Santa Fe County Ordinance No. 1989-10. This 1989 Ordinance enumerated each of the five districts and listed the individual precincts that comprise each district. Ordinance 1992-7 reassigned precincts to each district based upon the 1990 Census. Ordinance 2001-13 reassigned precincts to each district based upon the 2000 Census. The attached Ordinance, 2011-____, will reassign precincts to each district based upon the 2010 Census and the redistricting plan selected by the Board.

The Board has reviewed eleven (11) separate redistricting plan scenarios and studied the feasibility of additional modifications to several of these plans. By consensus actions, the Board has reduced the number of redistricting plan options down to a final two (2) plans, Option C2 and Option C3. Maps of each of these options, a narrative option description document, a statistical summary table and the Ordinance that will formally adopt the final redistricting plan are attached.

Action

Two (2) redistricting plan options are presented for the Board's final review, consideration and discussion today. Following the second formal Public Hearing on these redistricting plan options, the Board should select a final plan. The Board will formally and officially adopt the 2011 County Commission Redistricting Plan by voting to enact the attached Ordinance with the precinct listing that corresponds to the selected final redistricting plan.

THE BOARD OF COUNTY COMMISSIONERS OF
SANTA FE COUNTY, NEW MEXICO

ORDINANCE NO. 2011-_____

AN ORDINANCE
ADOPTING THE SANTA FE COUNTY REDISTRICTING PLAN, AMENDING
ORDINANCE NO. 1989-10, AND REPEALING ORDINANCE NO. 2001-13, TO
REASSIGN PRECINCTS ACCORDING TO THE FIVE COMMISSION DISTRICTS,
IN ACCORDANCE WITH THE 2010 U.S. CENSUS AND ACCORDING TO
COUNTY REDISTRICTING

WHEREAS, Santa Fe County Ordinance No. 1989-10 enumerates the five commission districts and sets forth those precincts which comprise those commission districts;

WHEREAS, Santa Fe County Ordinance No. 2001-13 amended Ordinance No. 1989-10 by reassigning precincts according to the five commission districts, in accordance with the 2000 U.S. Census; and

WHEREAS, the lines dividing and setting forth the five commission districts for the County of Santa Fe should be redrawn in accordance with the 2010 U.S. Census.

NOW THEREFORE, BE IT ORDAINED by the Board of County Commissioners of Santa Fe County that:

- A. This Ordinance repeals and replaces Ordinance No. 2001-13.
- B. Ordinance No. 1989-10, Section 2 is hereby deleted, and the following is inserted in its place to implement the 2011 redistricting plan approved by the Board of County Commissioners:

SECTION 2
COUNTY COMMISSION DISTRICTS

Section 2.1 NUMBERS: As of the first day of January, 1991, the County shall be divided by precinct into five compact, contiguous, and substantially equally populated county commission districts as follows:

Section 2.2 DISTRICT 1: County Commission district ONE shall be comprised of the following precincts: 1, 2, 3, 4, 5, 6, 7, 8, 10, 20, 21, 22, 23, 25, 26, 27, 28, 30, 40, 58, 59, 60, 61, 79, 83, 87

Section 2.3 DISTRICT 2: County Commission district TWO shall be comprised of the following precincts: 11, 24, 31, 32, 33, 34, 64, 66, 67, 80, 82.

Section 2.4 DISTRICT 3: County Commission district THREE shall be comprised of the following precincts: 12, 15, 16, 17, 18, 19, 62, 72, 73, 75, 84, 85, 86.

Section 2.5 DISTRICT 4: County Commission district FOUR shall be comprised of the following precincts: 9, 13, 36, 37, 41, 42, 43, 44, 45, 46, 47, 48, 51, 52, 53, 54, 55, 57, 63, 68, 77, 81.

Section 2.6 DISTRICT 5: County Commission district FIVE shall be comprised of the following precincts: 14, 29, 35, 38, 39, 49, 50, 56, 65, 69, 70, 71, 74, 76, 78, 88.

- C. This Ordinance shall become effective thirty days after it is duly recorded by the Santa Fe County Clerk.

PASSED AND ENACTED THIS _____ DAY OF _____, 2011.

**THE BOARD OF COUNTY COMMISSIONERS
OF SANTA FE COUNTY, NEW MEXICO**

By _____
Virginia Vigil, Chair

ATTEST:

Valerie Espinoza, Santa Fe County Clerk

APPROVED AS TO FORM:



Stephen C. Ross, Santa Fe County Attorney

THE BOARD OF COUNTY COMMISSIONERS OF
SANTA FE COUNTY, NEW MEXICO

ORDINANCE NO. 2011-_____

AN ORDINANCE

ADOPTING THE SANTA FE COUNTY REDISTRICTING PLAN, AMENDING
ORDINANCE NO. 1989-10, AND REPEALING ORDINANCE NO. 2001-13, TO
REASSIGN PRECINCTS ACCORDING TO THE FIVE COMMISSION DISTRICTS,
IN ACCORDANCE WITH THE 2010 U.S. CENSUS AND ACCORDING TO
COUNTY REDISTRICTING

WHEREAS, Santa Fe County Ordinance No. 1989-10 enumerates the five commission districts and sets forth those precincts which comprise those commission districts;

WHEREAS, Santa Fe County Ordinance No. 2001-13 amended Ordinance No. 1989-10 by reassigning precincts according to the five commission districts, in accordance with the 2000 U.S. Census; and

WHEREAS, the lines dividing and setting forth the five commission districts for the County of Santa Fe should be redrawn in accordance with the 2010 U.S. Census.

NOW THEREFORE, BE IT ORDAINED by the Board of County Commissioners of Santa Fe County that:

- A. This Ordinance repeals and replaces Ordinance No. 2001-13.
- B. Ordinance No. 1989-10, Section 2 is hereby deleted, and the following is inserted in its place to implement the 2011 redistricting plan approved by the Board of County Commissioners:

SECTION 2
COUNTY COMMISSION DISTRICTS

Section 2.1 NUMBERS: As of the first day of January, 1991, the County shall be divided by precinct into five compact, contiguous, and substantially equally populated county commission districts as follows:

Section 2.2 DISTRICT 1: County Commission district ONE shall be comprised of the following precincts: 1, 2, 3, 4, 5, 6, 7, 8, 9, 10, 20, 21, 22, 23, 25, 26, 28, 30, 40, 58, 59, 60, 61, 79, 83, 87.

Section 2.3 DISTRICT 2: County Commission district TWO shall be comprised of the following precincts: 11, 24, 31, 32, 33, 34, 64, 66, 67, 80, 82.

C3

Section 2.4 DISTRICT 3: County Commission district THREE shall be comprised of the following precincts: 12, 15, 16, 17, 18, 19, 62, 72, 73, 75, 84, 85, 86.

Section 2.5 DISTRICT 4: County Commission district FOUR shall be comprised of the following precincts: 13, 27, 36, 37, 41, 42, 43, 44, 45, 46, 47, 48, 51, 52, 53, 54, 55, 57, 63, 68, 77, 81.

Section 2.6 DISTRICT 5: County Commission district FIVE shall be comprised of the following precincts: 14, 29, 35, 38, 39, 49, 50, 56, 65, 69, 70, 71, 74, 76, 78, 88.

C. This Ordinance shall become effective thirty days after it is duly recorded by the Santa Fe County Clerk.

PASSED AND ENACTED THIS _____ DAY OF _____, 2011.

**THE BOARD OF COUNTY COMMISSIONERS
OF SANTA FE COUNTY, NEW MEXICO**

By _____
Virginia Vigil, Chair

ATTEST:

Valerie Espinoza, Santa Fe County Clerk

APPROVED AS TO FORM:



Stephen C. Ross, Santa Fe County Attorney

Introduction

The release of the 2010 Decennial Census data by the US Census Bureau for the State of New Mexico and Santa Fe County revealed that Santa Fe County's five (5) County Commissioner Districts must be adjusted in order to balance population as equally as possible among each of the five districts. Santa Fe County, with a total 2010 base population of 144,170 persons, ideally should have five (5) County Commissioner Districts composed of 28,834 persons per District (144,170/5). In the context of state and local districting, the Federal Courts have generally viewed population deviations of five percent or less between districts as substantially satisfying the equalized population requirement of "one person, one vote". Applied to Santa Fe County, this five percent allowable deviation translates to an allowance of +/- 1,442 people (5% of 28,834) per district. In other words, each proposed realigned Commissioner District should contain no more than 30,276 persons and no less than 27,392 persons (28,834 +/- 1,442).

An analysis of the current County Commissioner Districts with the 2010 Census population figures shows that Districts 1, 2 and 4 are under the ideal population of 28,834 persons, while Districts 3 and 5 are over this ideal population.

<i>Commissioner District</i>	<i>2010 Population per District</i>	<i>Deviation (max +/- 5%)</i>	
1	26,023	-2,811	-9.75%
2	28,164	-670	-2.32%
3	32,842	4,008	13.90%
4	26,045	-2,789	-9.67%
5	31,096	2,262	7.84%

Any redistricting scenarios/plans developed for consideration should adhere to the following basic principles of districting:

- Equal Population
- Avoid Dilution of Minority Voting Strength
- Compactness
- Contiguity
- Maintenance of Communities of Interest

The Santa Fe County Board of County Commissioners in reviewing this analysis and guided by these basic principles requested that several variations of redistricting plans be prepared. A narrative description of each of redistricting plans currently being considered by the Board is provided on the following pages. The current redistricting options are Option C2 and Option C3.

Description & Summary of Santa Fe County Redistricting Options

Option C2

Redistricting Option C2 is a variant of a redistricting scenario that strives to use predominately major roads & visible features (e.g., rivers, railroads) as district boundaries.

District 1 picks up four precincts west of St. Francis (pcts. 20, 21, 25 & 83) from District 2, and loses two precincts (pcts. 9 & 36) to District 4.

Additions:

Precincts 20, 21, 25 & 83 (Monte Sereno/Tano Road/La Tierra/Las Dos/Piñon Ridge/Casa Solana/Alto Park areas) from District 2

East: St. Francis/US 84/285

North: Tesuque Pueblo

West: Calle Adelina/Paseo de la Tierra/Alamo Creek/Paseo de Aguila/Lluvia de Oro/Fin del Sendero/Camino la Tierra/Buckman Road/Paseo de Vistas/Rincon de Torreon/north bank of the Santa Fe River/Camino Alire

South: Agua Fria Street

Deletions:

Precinct 9 (Aspen Basin/Hyde Park Estates/Cerro Gordo/Valle Lejano areas) to District 4

East: San Miguel County

North & West: NM 475 - Hyde Park Road/Gonzales Road

South: East Alameda/Santa Fe River

Precinct 36 (Capitol area) to District 4

East: Old Santa Fe Trail/Arroyo Tenorio/Garcia Street/Canyon Road/Paseo de Peralta

North: East Alameda/West Alameda

West: South Guadalupe

South: Paseo de Peralta/West Santa Fe Avenue/Don Gaspar/Buena Vista Street

District 2 picks up two precincts (pcts. 64 & 67) from District 3, and loses seven precincts; four to District 1 (pcts. 20, 21, 25 & 83) and three to District 4 (pcts. 43, 44 & 45).

Additions:

Precincts 64 & 67 (Las Acequias/Fairway Village/County Club Gardens MHP/Tierra Real areas) from District 3

East: Lopez Lane

Northwest: Agua Fria Street

South: Airport Road

Deletions:

Precincts 20, 21, 25 & 83 (Monte Sereno/Tano Road/La Tierra/Las Dos/Piñon Ridge/Casa Solana/Alto Park areas) to District 1
(described above in District 1)

Precincts 43, 44 & 45 (South Capitol/West Cordova Road areas) to District 4

East: Old Pecos Trail

North: Buena Vista Street/Don Gaspar/West Santa Fe Avenue/Paseo de Peralta

West: South Guadalupe/Cerrillos Road

South: Alta Vista/Galisteo/East Cordova/Don Gaspar/East Lupita

District 3 picks up one precinct (pct. 75) from District 5 and loses two precincts (pcts. 64 & 67) to District 2.

Additions:

Precinct 75 (Camino Entrada/Jaguar Drive area) from District 5

Description & Summary of Santa Fe County Redistricting Options

East: Cerrillos Road
North: Airport Road
West: Paseo del Sol
South: Ocate Road

Deletions:

Precincts 64 & 67 (Las Acequias/Fairway Village/County Club Gardens MHP/Tierra Real areas) to District 2
(described above in District 2)

District 4 picks up six precincts, two from District 1 (pcts. 9 & 36), three from District 2 (pcts. 43, 44 & 45) and one from District 5 (pct. 63); and loses three precincts (pcts. 35, 50 & 76) to District 5.

Additions:

Precincts 9 & 36 (Aspen Basin/Hyde Park Estates/Cerro Gordo/Valle Lejano/Capitol areas) from District 1

(described above in District 1)

Precincts 43, 44 & 45 (South Capitol/West Cordova Road areas) from District 2

(described above in District 2)

Precinct 63 (Lamy/Spirit Wind Ranch/East 285 Corridor/Old Ranch/East Ranch/The Ridges/Los Vaqueros /West Cañoncito areas) from District 5

Southeast: BNSF Railroad

North: I-25

West: US 285

Deletions:

Precincts 35, 50 & 76 (College of Santa Fe/Los Cedros areas) to District 5

East: Yucca/Siringo Road/Llano Street/St. Michaels Drive

North: Cerrillos Road

West: Camino Carlos Rey

South: Rodeo Road

District 5 picks up three precincts (pcts. 35, 50 & 76) from District 4 and loses two precincts, one to District 3 (pct. 75) and one to District 4 (pct. 63).

Additions:

Precincts 35, 50 & 76 (College of Santa Fe/Los Cedros areas) from District 4
(described above in District 4)

Deletions:

Precinct 75 (Camino Entrada/Jaguar Drive area) to District 3
(described above in District 3)

Precinct 63 (Lamy/Spirit Wind Ranch/East 285 Corridor/Old Ranch/East Ranch/The Ridges/Los Vaqueros /West Cañoncito areas) to District 4

(described above in District 4)

Description & Summary of Santa Fe County Redistricting Options

Option C3

Redistricting Option C3 is a variant of a redistricting scenario that strives to use predominately major roads & visible features (e.g., rivers, railroads) as district boundaries.

District 1 picks up four precincts west of St. Francis (pcts. 20, 21, 25 & 83) from District 2, and loses two precincts (pcts. 27 & 36) to District 4.

Additions:

Precincts 20, 21, 25 & 83 (Monte Sereno/Tano Road/La Tierra/Las Dos/Piñon Ridge/Casa Solana/Alto Park areas) from District 2

East: St. Francis/US 84/285

North: Tesuque Pueblo

West: Calle Adelina/Paseo de la Tierra/Alamo Creek/Paseo de Aguila/Lluvia de Oro/Fin del Sendero/Camino la Tierra/Buckman Road/Paseo de Vistas/Rincon de Torreon/north bank of the Santa Fe River/Camino Alire

South: Agua Fria Street

Deletions:

Precinct 27 & 36 (Capitol/Westside Guadalupe areas) to District 4

East: Old Santa Fe Trail/Arroyo Tenorio/Garcia Street/Canyon Road/Paseo de Peralta

North: East Alameda/West Alameda

West: St. Francis Drive

South: Cerrillos Road/South Guadalupe/Paseo de Peralta/West Santa Fe Avenue/Don Gaspar/Buena Vista Street

District 2 picks up two precincts (pcts. 64 & 67) from District 3, and loses seven precincts; four to District 1 (pcts. 20, 21, 25 & 83) and three to District 4 (pcts. 43, 44 & 45).

Additions:

Precincts 64 & 67 (Las Acequias/Fairway Village/County Club Gardens MHP/Tierra Real areas) from District 3

East: Lopez Lane

Northwest: Agua Fria Street

South: Airport Road

Deletions:

Precincts 20, 21, 25 & 83 (Monte Sereno/Tano Road/La Tierra/Las Dos/Piñon Ridge/Casa Solana/Alto Park areas) to District 1

(described above in District 1)

Precincts 43, 44 & 45 (South Capitol/West Cordova Road areas) to District 4

East: Old Pecos Trail

North: Buena Vista Street/Don Gaspar/West Santa Fe Avenue/Paseo de Peralta

West: South Guadalupe/Cerrillos Road

South: Alta Vista/Galisteo/East Cordova/Don Gaspar/East Lupita

District 3 picks up one precinct (pct. 75) from District 5 and loses two precincts (pcts. 64 & 67) to District 2.

Additions:

Precinct 75 (Camino Entrada/Jaguar Drive area) from District 5

East: Cerrillos Road

North: Airport Road

Description & Summary of Santa Fe County Redistricting Options

West: Paseo del Sol

South: Ocate Road

Deletions:

Precincts 64 & 67 (Las Acequias/Fairway Village/County Club Gardens MHP/Tierra Real areas) to District 2
(described above in District 2)

District 4 picks up six precincts, two from District 1 (pcts. 27 & 36), three from District 2 (pcts. 43, 44 & 45) and one from District 5 (pct. 63); and loses three precincts (pcts. 35, 50 & 76) to District 5.

Additions:

Precincts 27 & 36 (Capitol/Westside Guadalupe areas) from District 1
(described above in District 1)

Precincts 43, 44 & 45 (South Capitol/West Cordova Road areas) from District 2
(described above in District 2)

Precinct 63 (Lamy/Spirit Wind Ranch/East 285 Corridor/Old Ranch/East Ranch/The Ridges/Los Vaqueros /West Cañoncito areas) from District 5

Southeast: BNSF Railroad

North: I-25

West: US 285

Deletions:

Precincts 35, 50 & 76 (College of Santa Fe/Los Cedros areas) to District 5

East: Yucca/Siringo Road/Llano Street/St. Michaels Drive

North: Cerrillos Road

West: Camino Carlos Rey

South: Rodeo Road

District 5 picks up three precincts (pcts. 35, 50 & 76) from District 4 and loses two precincts, one to District 3 (pct. 75) and one to District 4 (pct. 63).

Additions:

Precincts 35, 50 & 76 (College of Santa Fe/Los Cedros areas) from District 4
(described above in District 4)

Deletions:

Precinct 75 (Camino Entrada/Jaguar Drive area) to District 3
(described above in District 3)

Precinct 63 (Lamy/Spirit Wind Ranch/East 285 Corridor/Old Ranch/East Ranch/The Ridges/Los Vaqueros /West Cañoncito areas) to District 4
(described above in District 4)

Option Summaries

Option C2 – Summary & Observations

Total Deviation: 1,335 persons or 4.6%

Urban vs. Rural Range: 47.8% (D5) to 72.0% (D2) with D1 50.5%, D3 58.2%, D4 70.6%

Observations:

- Total deviation is relatively low; highest deviation is District 1 at +2.8% (+793)
- Urban-Rural – Districts 1 & 3 improve; District 2 slight urban increase (2%), District 4 slight urban decrease (1.5%), District 5 minimal change
- Growth Accommodation: option achieves *limited* projected growth accommodation as Districts 3 & 5 (containing SDA1 areas) are under ideal population while District 1 is over ideal population & likely to be stable over next 10 years. Districts 2 & 4 have population deviations inverted, albeit slightly, from anticipated growth.
 - District 1 – good; 2.8% over ideal & likely to be stable population
 - District 2 – fair; 1.9% over ideal & likely to grow
 - District 3 – OK; -1.9% under ideal & likely to grow
 - District 4 – fair; -1.6% under ideal & likely to be stable population
 - District 5 – OK ; -1.2 % under ideal & likely to grow

Option C3 – Summary & Observations

Total Deviation: 1,119 persons or 3.9%

Urban vs. Rural Range: 47.8% (D5) to 72.0% (D2) with D1 50.1%, D3 58.2%, D4 70.8%

Observations:

- Total deviation is lowest of all options; highest deviation is District 1 at +2.0% (+577)
- Urban-Rural – Districts 1 & 3 improve; District 2 slight urban increase (2%), District 4 slight urban decrease (1.3%), District 5 minimal change
- Growth Accommodation: option achieves *limited* projected growth accommodation as Districts 3 & 5 (containing SDA1 areas) are under ideal population while District 1 is over ideal population & likely to be stable over next 10 years. Districts 2 & 4 have population deviations inverted, albeit slightly, from anticipated growth.
 - District 1 – OK; 2.0% over ideal & likely to be stable population
 - District 2 – fair; 1.9% over ideal & likely to grow
 - District 3 – OK; -1.9% under ideal & likely to grow
 - District 4 – fair; -0.9% under ideal & likely to be stable population
 - District 5 – OK ; -1.2 % under ideal & likely to grow

Population Breakdown of Current Santa Fe County Commission Districts and Proposed Redistricting Options

CURRENT CONDITIONS

2010 Total County Population by Race		Non-Hispanic Origin					Estimated Urban Population
Total Population	Ideal Population per Commission District	White	Native American	Black	Asian & Other	2 or More Races	86,201
144,170	28,834	63,291	3,271	947	1,963	1,683	59.8%
		43.9%	2.3%	0.7%	1.4%	1.2%	
		50.6%					
		73,015					

2010 Totals for Existing Commission Districts

Comm. Dist.	Pct. Cnt.	Population per District	Deviation (max +/- 5%)	Non-Hispanic Origin					Estimated Urban Population
				White	Native American	Black	Asian & Other	2 or More Races	
1	24	26,023	-2,811	9,654	1,635	118	279	248	12,120
			-9.75%	37.1%	6.3%	0.5%	1.1%	1.0%	48.6%
2	16	28,164	-670	12,430	338	165	355	312	19,166
			-2.32%	44.1%	1.2%	0.6%	1.3%	1.1%	68.0%
3	14	32,842	4,008	12,711	461	203	429	356	21,003
			13.90%	38.7%	1.4%	0.6%	1.3%	1.1%	64.0%
4	19	26,045	-2,789	14,230	320	185	445	379	18,776
			-9.67%	54.6%	1.2%	0.7%	1.7%	1.5%	72.1%
5	15	31,096	2,262	14,266	517	276	455	388	15,136
			7.84%	45.9%	1.7%	0.9%	1.5%	1.2%	48.7%

Totals for Proposed Redistricting Options

Comm. Dist.	Pct. Cnt.	Population per District	Deviation (max +/- 5%)	Non-Hispanic Origin					Estimated Urban Population
				White	Native American	Black	Asian & Other	2 or More Races	

Option C2

1	26	29,627	793	11,839	1,696	146	358	335	14,951
			2.75%	40.0%	5.7%	0.5%	1.2%	1.1%	50.5%
2	11	29,385	551	8,499	362	163	264	245	21,160
			1.91%	28.9%	1.2%	0.6%	0.9%	0.8%	72.0%
3	13	28,292	-542	12,204	405	177	445	324	16,453
			-1.88%	43.1%	1.4%	0.6%	1.6%	1.1%	58.2%
4	22	28,369	-465	16,782	308	193	484	396	20,026
			-1.61%	59.2%	1.1%	0.7%	1.7%	1.4%	70.6%
5	16	28,497	-337	13,967	500	268	412	383	13,611
			-1.17%	49.0%	1.8%	0.9%	1.4%	1.3%	47.8%

Option C3

1	26	29,411	577	11,838	1,670	140	354	314	14,735
			2.00%	40.3%	5.7%	0.5%	1.2%	1.1%	50.1%
2	11	29,385	551	8,499	362	163	264	245	21,160
			1.91%	28.9%	1.2%	0.6%	0.9%	0.8%	72.0%
3	13	28,292	-542	12,204	405	177	445	324	16,453
			-1.88%	43.1%	1.4%	0.6%	1.6%	1.1%	58.2%
4	22	28,585	-249	16,783	334	199	488	417	20,242
			-0.86%	58.7%	1.2%	0.7%	1.7%	1.5%	70.8%
5	16	28,497	-337	13,967	500	268	412	383	13,611
			-1.17%	49.0%	1.8%	0.9%	1.4%	1.3%	47.8%

Notes: "Ideal Population" by District is 28,834 people (144,170/5) with an allowance of +/- 1,442 people (5% of 28,834).
 Options B, B2, C, C1, D and D1 were eliminated from further consideration at August 30, 2011 County Commission meeting.
 Options A, B1 and C4 were eliminated from further consideration at September 27, 2011 County Commission meeting.

Santa Fe County 2011 Redistricting Option C2

DRAFT

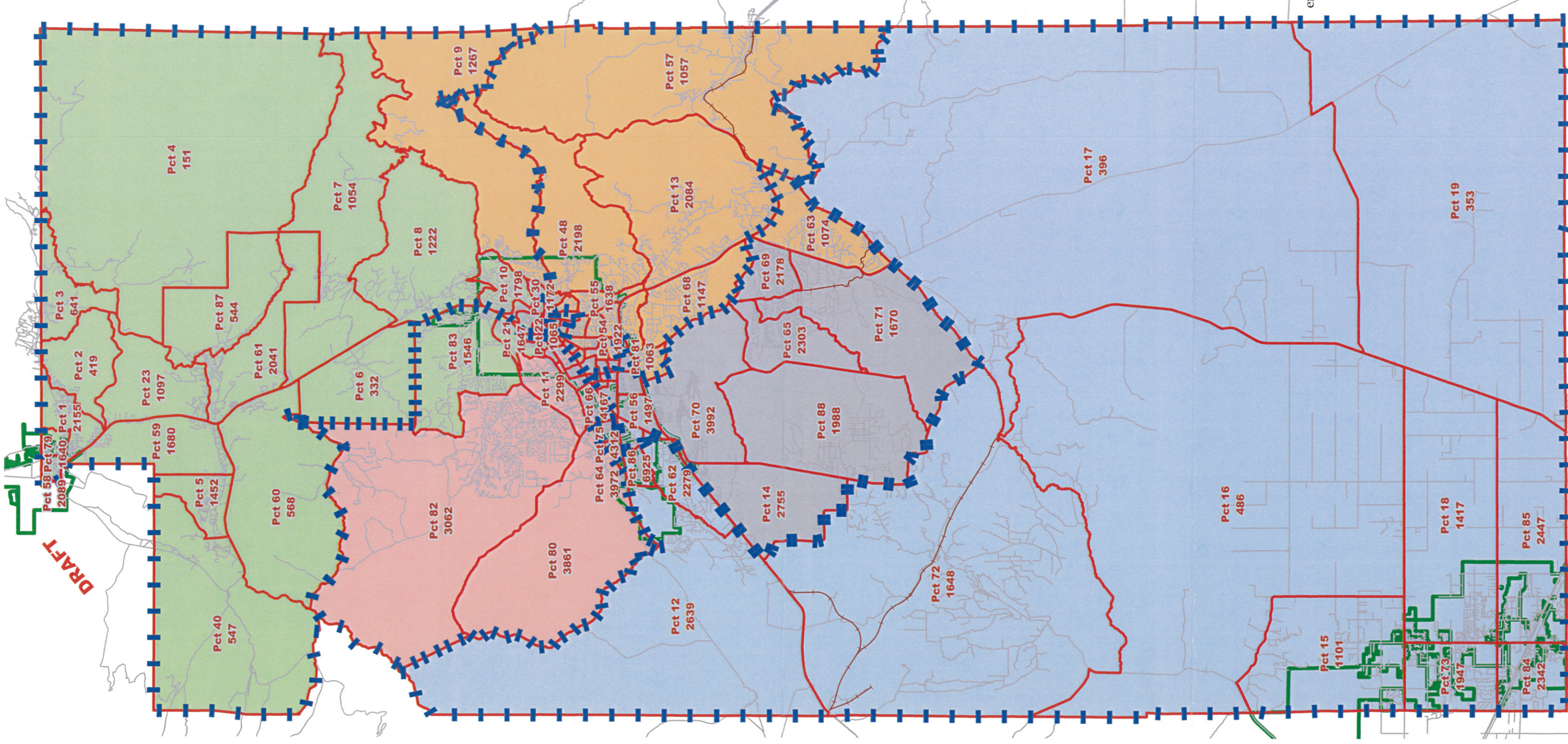

Legend

Redistricting Option C2



District 1



District 2



District 3



District 4



District 5



Former District Boundaries



2011 Precinct Boundaries



Incorporated Areas



Roads



Railroads

1:260,000

1 inch approximately 4 miles

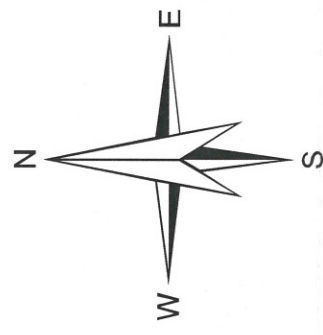

North American Vertical Datum 1988

This information is for reference only.
Santa Fe County assumes no liability for errors associated with the use of these data.
Users are solely responsible for confirming data accuracy.



DRAFT

Santa Fe County 2011 Redistricting Option C2

DRAFT

Legend

Redistricting Option C2

- District 1
- District 2
- District 3
- District 4
- District 5
- Former District Boundaries
- 2011 Precinct Boundaries
- Incorporated Areas
- Roads

1:63,360

1 inch represents 1 mile

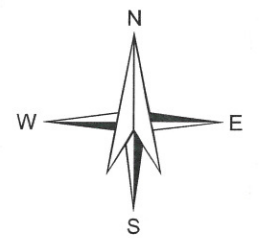
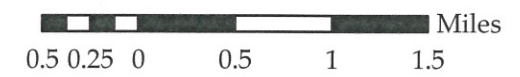

North American Vertical Datum 1988

This information is for reference only.
 Santa Fe County assumes no liability for
 errors associated with the use of these data.
 Users are solely responsible for
 confirming data accuracy.



August 24, 2011

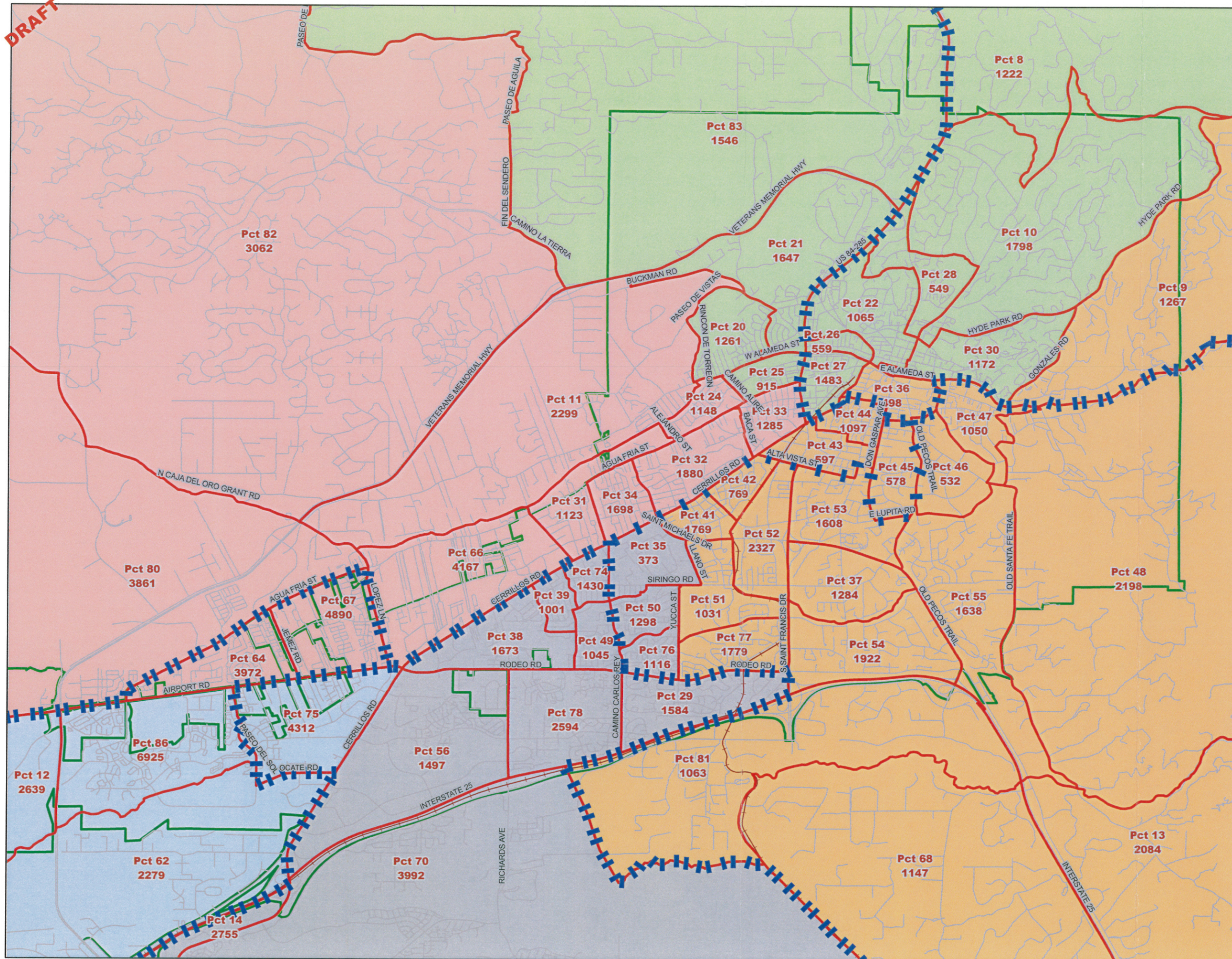

Santa Fe County 2011 Redistricting Option C3

DRAFT

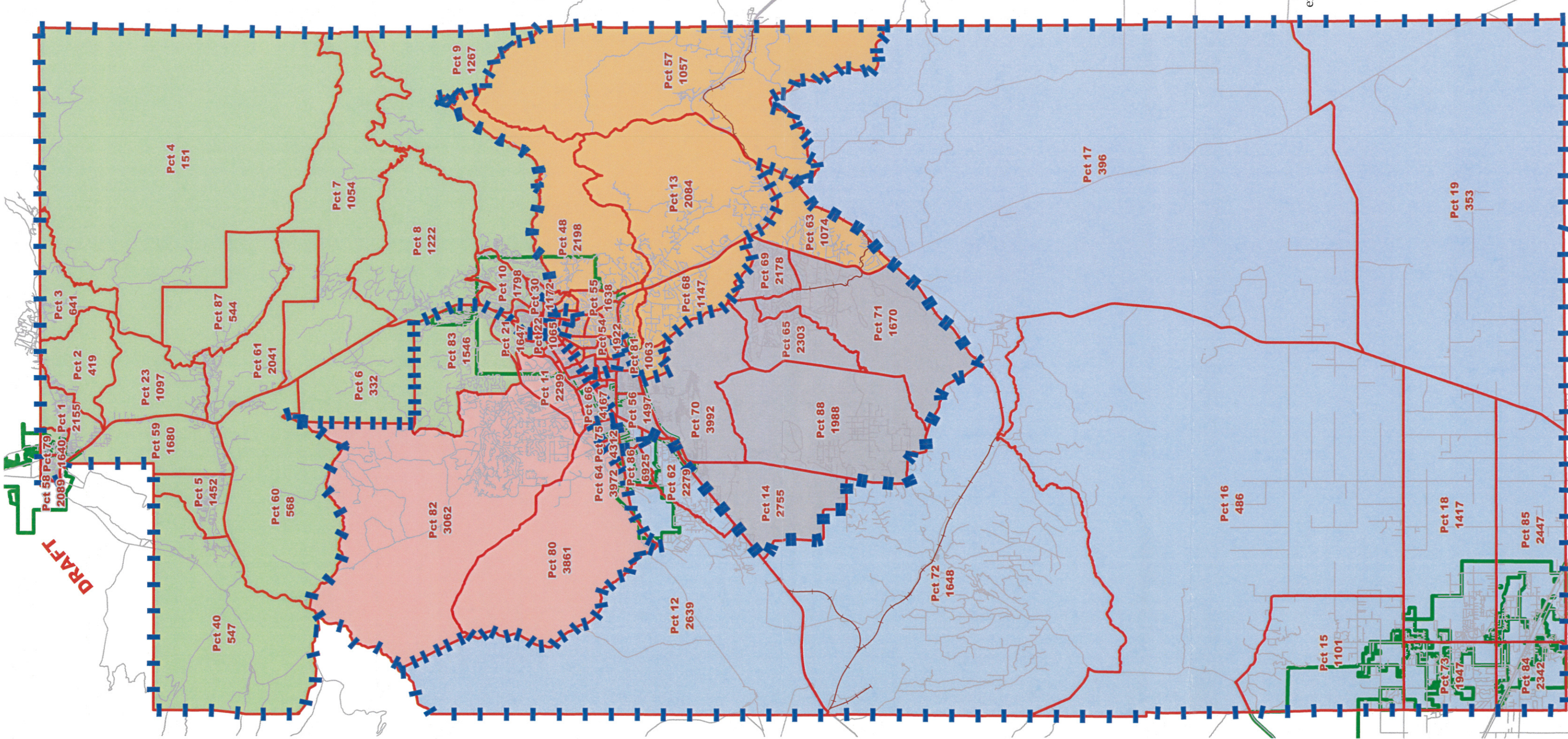

Legend

- Redistricting Option C3
- District 1
 - District 2
 - District 3
 - District 4
 - District 5
 - Former District Boundaries
 - 2011 Precinct Boundaries
 - Incorporated Areas
 - Roads
 - Railroads

1:260,000

1 inch approximately 4 miles

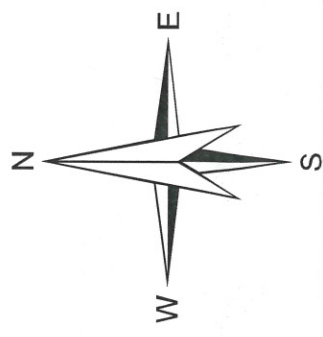

North American Vertical Datum 1988

This information is for reference only.
Santa Fe County assumes no liability for errors associated with the use of these data.
Users are solely responsible for confirming data accuracy.



DRAFT

Santa Fe County 2011 Redistricting Option C3

DRAFT

Legend

Redistricting Option C3

- District 1
- District 2
- District 3
- District 4
- District 5
- Former District Boundaries
- 2011 Precinct Boundaries
- Incorporated Areas
- Roads

1:63,360

1 inch represents 1 mile

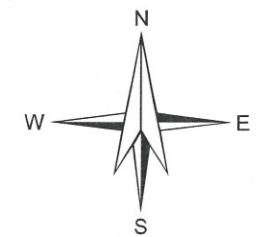
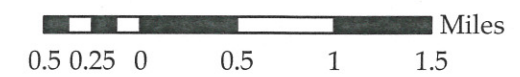

North American Vertical Datum 1988

This information is for reference only.
 Santa Fe County assumes no liability for
 errors associated with the use of these data.
 Users are solely responsible for
 confirming data accuracy.



August 24, 2011

